

CONTRACTOR:	
PROJECT:	DATE:
PREPARED BY:	MODEL#: CMS180BZ

**SERIES SPECIFICATIONS**



**CMS180BZ**

The CMS180BZ series of motion sensors are for the CMS series security lights



**FEATURES & SPECIFICATIONS**

**Intended Use**

For use with CMS series security lights.

**Construction**

The body is constructed of durable polycarbonate.

**Installation**

Sensor screws into housing on CMS series security lights.

**Input Voltage**

120 VAC

**Listings**

ETL listed to US and Canadian safety standards. Wet location listed. For use in ambient operating temperatures ranging from -20°C to 40°C.

**Warranty**

3-year limited warranty.

**NOTE:** Actual performance may differ as a result of end-user environment and application. All values are design or typical values, measured under laboratory conditions at 25 °C. Specifications subject to change without notice.

**LINE DRAWINGS**

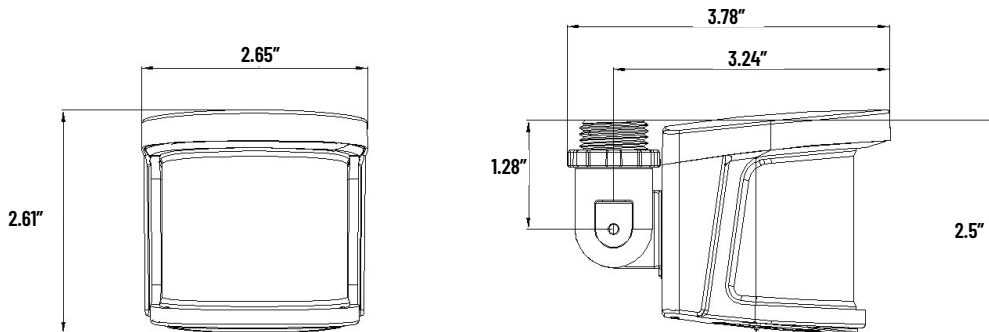

**ORDERING INFORMATION**

Example: CMS180BZ

SERIES	COVERAGE	COLOR
CMS	[180]: 180°	[BZ]: Bronze