

MODEL :		TYPE
PROJECT :		
PREPARED BY :	DATE :	

SERIES SPECIFICATIONS

The TALRT16KIT-CWG2 includes everything needed to bring white color options to any job or installation. Cool white color ribbon tape will allow you to create the perfect ambience to suit any mood desired. The 16' spool can be cut & spliced every 3 inches on clearly marked cut points to create custom lengths for your installation needs. Splice connectors included will allow you to add angles and jump gaps. Each kit also includes end caps and heat shrink tubes that will reseal the tape to maintain the integrity of the IP65 rating. This kit provides a basic and easy way to change the overall feel and ambience of any space or project.



LINE DRAWING

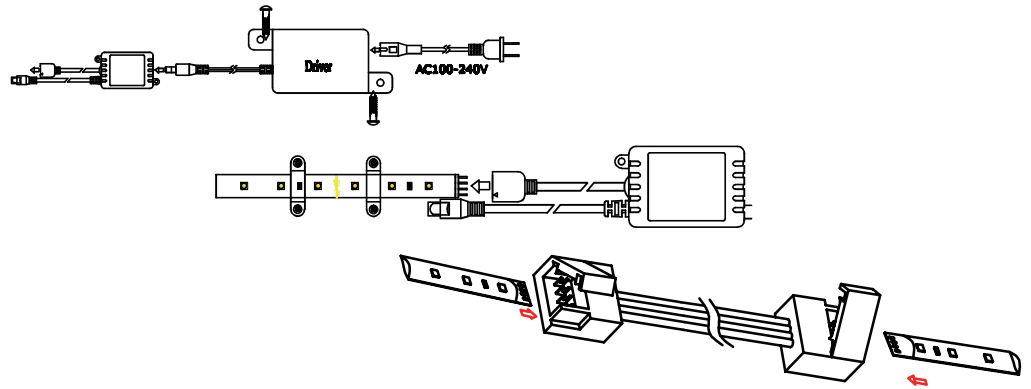
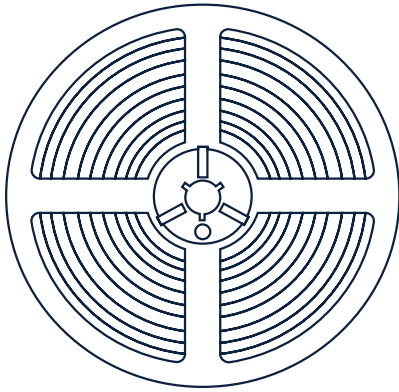

CONSTRUCTION

Sealing Material
PU Glue

LEDs per In.
30 LED/19.7In.

Lumens Per Ft.
121 lm/Ft

Watts Per Ft
1.46W/Ft

Max Run Length
32Ft.

Cuttable Length
1.96In.

DIMMING SPECIFICATIONS*

Dimmable
Yes

Dimming %
0-100%

Driver Type
Electronic

MODEL :		TYPE
PROJECT :		
PREPARED BY :	DATE :	

ELECTRICAL SPECIFICATIONS

Input Voltage
100-240 VAC

Efficacy
117 LM/W

LED Lifespan
>30,000 HRS

Frequency
60Hz

CRI
< 70

Operating Temp
-20°C ~ +40°C

Input Current
1.6A Max

Drive Current
300mA

IR Controller Input
12V D.C.

Input Wattage
36W

Lumens
1700+ Lumens

IR Controller Current
0.3A Max

Power Factor
≥ 0.6

IR Controller Output
12V D.C.

Color Temp
5800-6300K

PERFORMANCE SPECIFICATIONS

SPECTRAL POWER DISTRIBUTION & CHROMATICITY DIAGRAM

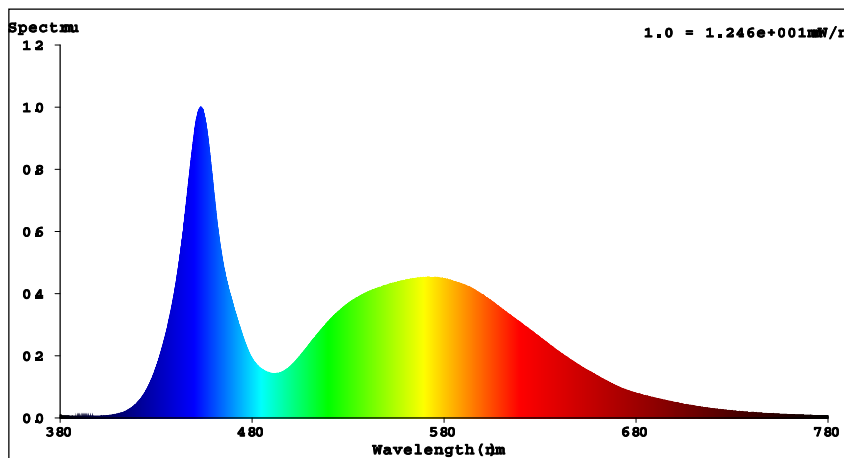

Spectral Distribution

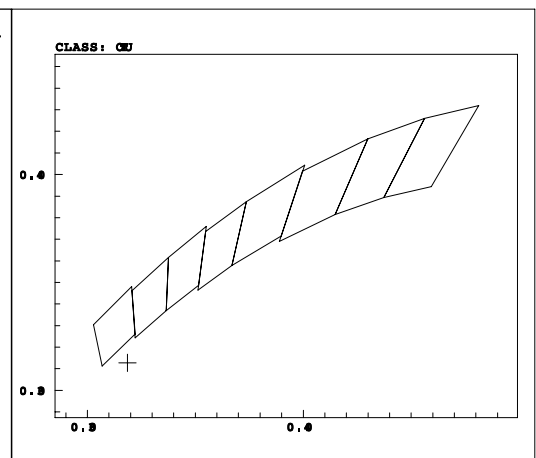

CIE1931 Chromaticity Diagram

MODEL :		TYPE
PROJECT :		
PREPARED BY :	DATE :	

ADHESIVE SPECIFICATIONS**

Tensile Strength
 688 kg/m³ (43 lb/ft³)
 Min. 608 kg/m³ (38 lb/ft³)
 Max. 768 kg/m³ (48 lb/ft³)

Adhesion Strength to Backing
 688 kg/m³ (43 lb/ft³)
 Min. 608 kg/m³ (38 lb/ft³)
 Max. 768 kg/m³ (48 lb/ft³)

Adhesion Strength to Polypropylene
 Breakaway and Continuing Peel tests
 are run with 12.7 mm (0.5 in.) wide
 tape on PVC test bars

Temp. Resistance Min/Hours
 72 hrs. at 22°C (72°F) (Break-
 away and Continuing Peel)

Temp. Resistance Days/Weeks
 Exceeds 100 hours at 70°C (158°F)
 (Static Shear)

CERTIFICATIONS/WARRANTY

Listing
 UL Listed

IP Rating
 IP65

Location Rating:
 Tape Suitable for wet locations
 Driver Suitable for dry locations only

Enclosure Rating
 Rated for cabinet enclosure

Warranty

Guaranteed for one year from the purchase date of the product, against mechanical defects in manufacturing.

ORDERING INFORMATION

Sample Part Number: TALRT16KIT-CWG2

Carton Dimensions: 188x190x54MM
 7.41x7.48x2.14IN

Case Dimensions: 410x390x215MM
 16.14x15.36x8.47IN

Case Quantity: 20 PCS

TALRT16KIT-	CW	G2
SERIES	COLOR TEMP	GENERATION
TALRT16KIT-	[CW]: COOL WHITE	[G2]: GENERATION 2

UPC BARCODES

	GTIN-12	GTIN-14	IMS Code
TALRT16KIT-CWG2	190010679232	00190010679232	0314-2515



NOTES

*Dimming is done by remote control & IR receiver (included) if wall dimming is needed the TALRT60DWT driver (sold separately) will be needed

**Tests were run on base coat/clear coat paint at a separation rate of 305 mm/min. (12 in./min.)