



MODEL:		TYPE
PROJECT:		
PREPARED BY:	DATE:	



COWS SERIES

The COWS has a slim body with a variety of different style covers to create different light effects for various needs.



FEATURES AND SPECIFICATIONS

INTENDED USE:

The COWS series is ideal for applications such as lighting walkways and stairways for safety and security.

CONSTRUCTION:

The body is constructed aluminum.

Finish: Paint after fabrication (PAF) adds high resistance to rust over its lifetime.

OPTICS:

High light transmittance transparent tempered glass.

ELECTRICAL:

70% lumen maintenance at >50,000 hours; predicted life of more than 80,000 hours. The COWS delivers up to 140 lumens per watt and LED Lumen maintenance of L80/80,000 hours. Driver disconnect is provided where required to comply with U.S. and Canadian codes. Thermally protected driver standard.

INSTALLATION:

Fixture comes standard with wall mount bracket. Optional face plates sold separately.

LISTINGS:

UL listed to US and Canadian safety standards. Wet location listed. For use in ambient operating temperatures ranging from -20°C to 40°C.

WARRANTY:

5-year limited warranty. Complete warranty terms located at:

www.tamliteusa.com/CustomerResources/Terms_and_conditions.asp

NOTE: Actual performance may differ as a result of end-user environment and application.

All values are design or typical values, measured under laboratory conditions at 25 °C. Specifications subject to change without notice.

LINE DRAWING

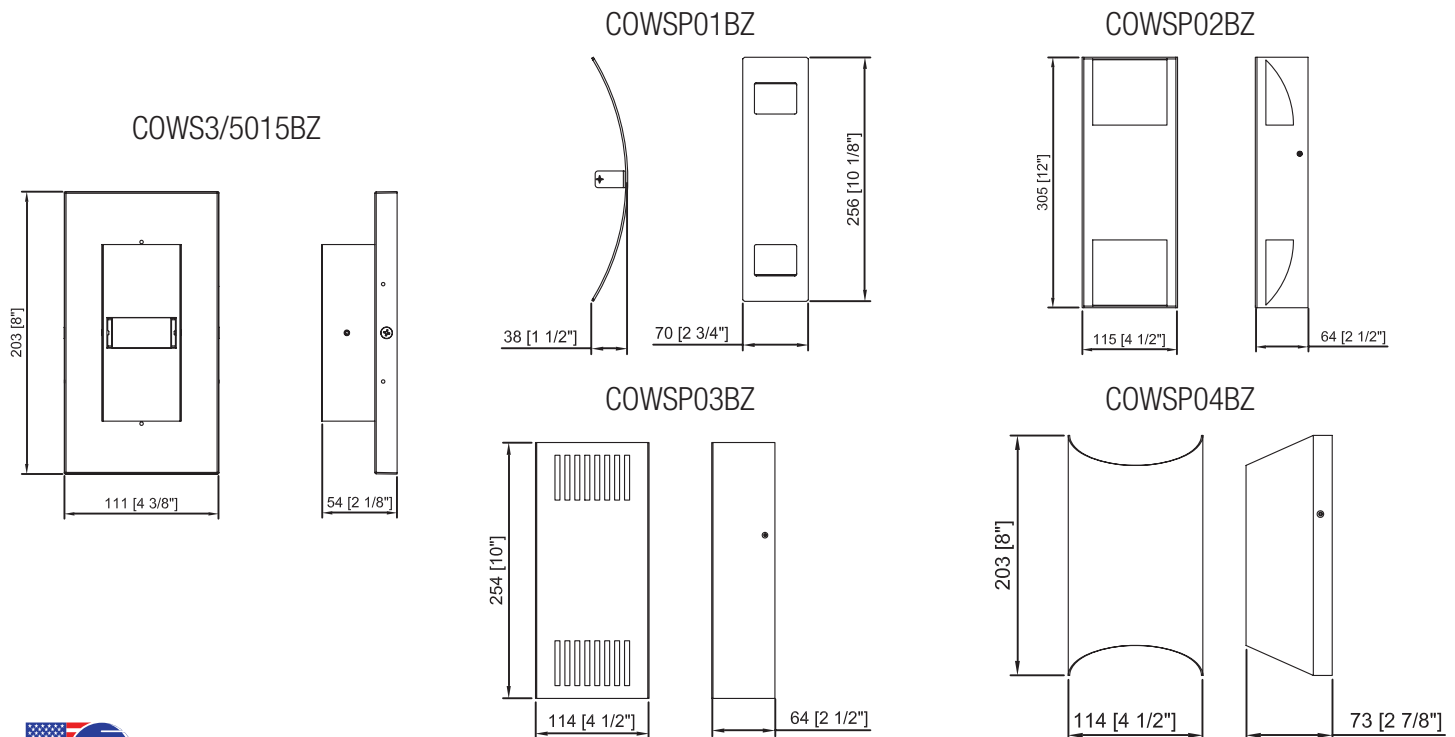

FIXTURE ORDERING INFORMATION

COWS			
SERIES	COLOR TEMP	WATTAGE	FINISH
COWS	[30] : 3000K [40] : 4000K [50] : 5000K	[15] : 15 Watts	[BZ] : Bronze [WH] : White

FACE PLATE ORDERING INFORMATION

COWSP		
SERIES	STYLE	FINISH
COWS	[01] : #1 [02] : #2 [03] : #3 [04] : #4	[BZ] : Bronze [WH] : White

PERFORMANCE SPECIFICATIONS

Lumens	LPW	Max Wattage	Max Amps
1300	90	15	0.18

GENERAL DRIVER INFORMATION	
ELECTRICAL SPECIFICATIONS	15W
Input	
Input Voltage (VAC)	90V-305V
Frequency Range (Hz)	50-60 Hz (+/- 10%)
Input Current Max (A) Per Driver	0.25
THD @ Full Load	<20%
Efficiency @ Full Load	86%
Inrush Current 100% Load at 230V Input Cold start	20A
Power Factor @ Full Load	>0.9
Output	
Output Voltage (VDC)	36-60VDC
Output Current (mA) Per Driver	250mA
Max. Output power (W) Per Driver	15W
Over Temp. Protection	Shutdown @ 120°C
LED Power Up Time	<1sec
Load Regulation	<10%
Line Regulation	<10%
Over Voltage Protection	Yes
Over Load Protection	Yes
Output Short-Circuit Protection	Yes

ENVIRONMENTAL SPECIFICATIONS	15W
Ambient Range	-40°C to 60°C
Max. Storage Temp.	85°C
MTBF	200,000 Hrs. TA=25°C
EMI Compliance	FCC Part 15 Class B

PHOTOMETRIC REPORTS

POLAR GRAPH

IES ROAD REPORT
PHOTOMETRIC FILENAME : COWS015BZ.IES
POLAR GRAPH

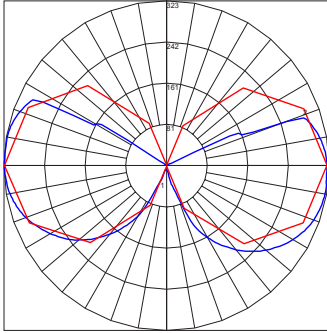

Maximum Candela = 322.7 Located At Horizontal Angle = 180, Vertical Angle = 91
1 - Vertical Plane Through Horizontal Angles (180, 0) (Through Max. Cd.)
2 - Horizontal Cone Through Vertical Angle (91) (Through Max. Cd.)

LUMINAIRE CLASSIFICATION GRAPH

IES ROAD REPORT
PHOTOMETRIC FILENAME : COWS015BZ.IES
LUMINAIRE CLASSIFICATION SYSTEM (LCS) GRAPH

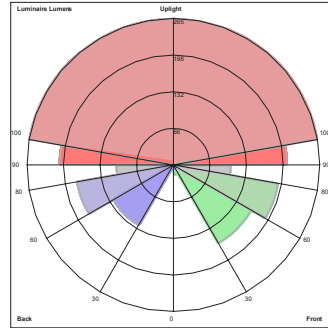

Luminaire Lumens:
Front: Low=17.9, Medium=93.7, High=193.1, Very High=104.6
Back: Low=5.3, Medium=22.4, High=177.4, Very High=103.7
Uplight: Low=206.4, High=264.6
BUG Rating: 81-US-02

ISOCANDELA PLOT

IES ROAD REPORT
PHOTOMETRIC FILENAME : COWS015BZ.IES
ISOCANDELA LINES OF HORIZONTAL ILLUMINANCE

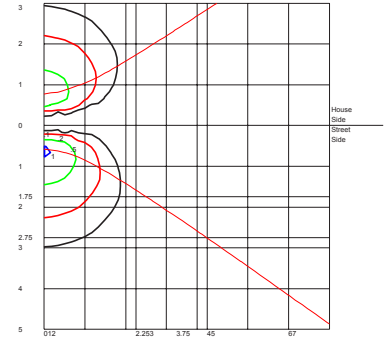

Distance In Units Of Mounting Height
Values Based On 10 Foot Mounting Height
1/2 Maximum Candela Trace Shown As Dashed Curve
(+) = Maximum Candela Point