

PRF SERIES

Voltage: Input 120V-277V.

1. Risk of Fire or electric shock - LED Retrofit Kit installation requires knowledge of luminaires electrical systems. If not qualified, do not attempt installation. Contact a qualified electrician.
2. Install this retrofit only in the luminaires that have the construction features and dimensions shown in the photographs and/or drawings.
3. Do not make or alter any open holes in an enclosure of wiring or electrical components during retrofit installation.
4. To prevent wiring damage or abrasion, do not expose wiring to edges of sheet metal or other sharp objects.

NOTICE:

Select desired color temperature by sliding switch on back of unit before installation.
 (Available CCTs are 2700K, 3000K, 3500K, 4000K, 5000K or 2700K, 3000K, 4000K, 5000K, 6500K.) (FIG.5)

INSTALLATION FOR LED 6" RETROFIT TRIM

1. Make sure the power is turned off at the source to the recessed housing(s) where the fixture(s) will be installed. Remove existing trim and CFL or incandescent bulbs.
2. Plug the female connector of the retrofit-kit into the male connector of the socket adapter assembly. (Fig. 2)
 (If you used E26 socket, please screw E26 socket adapter into socket in housing.) (Fig. 1)
3. Squeeze the torsion springs together as shown and install into torsion spring brackets inside the housing. (Fig. 4)
4. Tuck all wire into the housing and carefully push the RETROFIT TRIM up flush to ceiling surface.

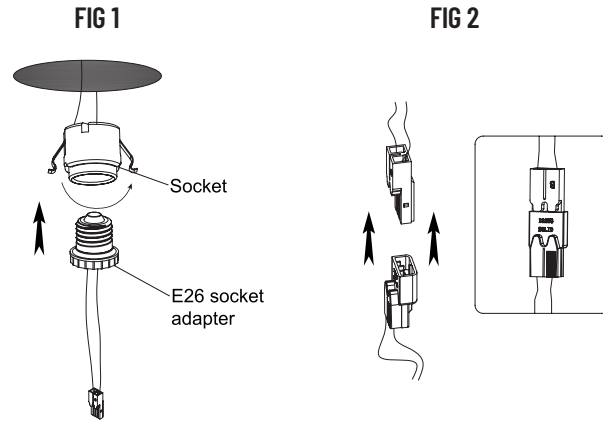

INSTALLATION FOR LED 4" RETROFIT TRIM

1. Make sure the power is turned off at the source to the recessed housing(s) where the fixture(s) will be installed. Remove existing trim and CFL or incandescent bulbs.
2. Plug the female connector of the retrofit-kit into the male connector of the socket adapter assembly. (Fig. 2) (If you used E26 socket, please screw E26 socket adapter into socket in housing.) (Fig. 1)
3. Tuck all wire into the housing and carefully push the RETROFIT TRIM up flush to ceiling surface. (Fig. 3)

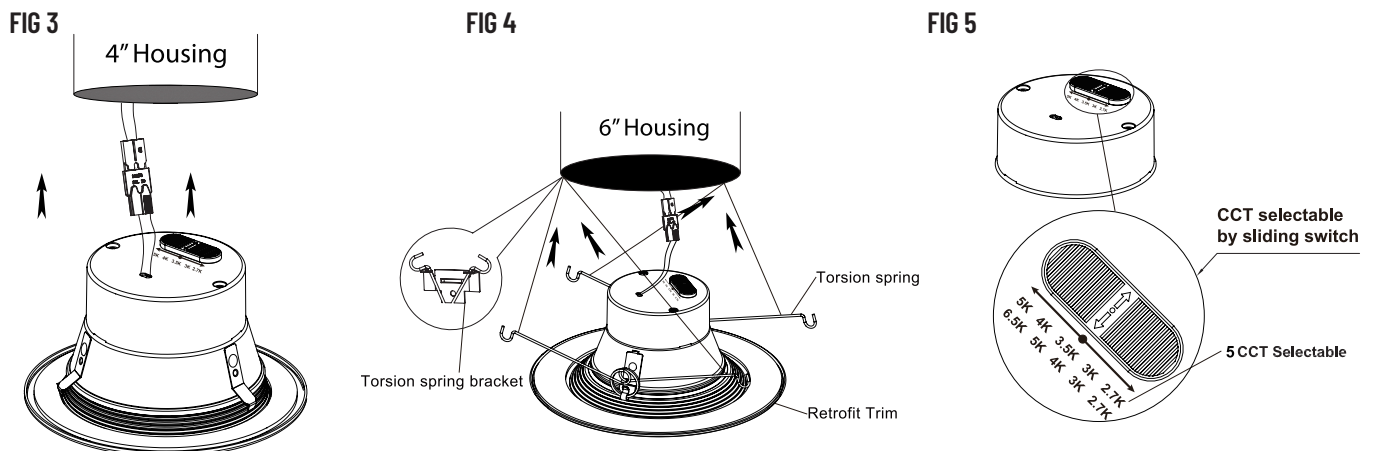

COMPATIBLE DIMMER LIST

NO	BRAND	DIMMER ITEM NO
1	LUTRON	MACL-153M-WH
2		DVCL-153P-WH
3		NLV-600
4		NTLV-600
5		N-600
6		NTELV-600
7		SCL-153P-WH
8		STCL-153M-WH
9		CTCL-153P
14	LEVITON	IPL06-10Z