

INSTALLATION INSTRUCTIONS

SPLWS INSTALLATION INSTRUCTIONS

For stadiums, shipyards, airports, docks, and other high pole installation application; can be used for long-distance small-angle projection and large architectural outline lighting.

CAUTION:

1. The product should be installed, inspected, and maintained by a qualified electrician in accordance with local national electrical safety regulations;
2. Please turn off the power before checking, installing, or removing;
3. Ensure that the voltage used is the voltage within the product identification range;
4. Use wires that comply with UL (or other local standards) for wiring. The voltage AC100-277V should be wired with not less than 16 AWG, and the voltage AC277-480V should be wire with not less than 18 AWG;
5. Do not install in a hazardous environment. The ambient temperature must not exceed the rated operating temperature of the product;
6. Do not install the product when it rains. Avoid the danger of lightning strikes and avoid accidents;
7. Please use with listed waterproof strain relief bushing when connecting the power supply cord to outlet box.
8. Can not use the electric generator to test the LED lamp.
9. External 0-10V only passive dimmers are supported.

WIRING DIAGRAM

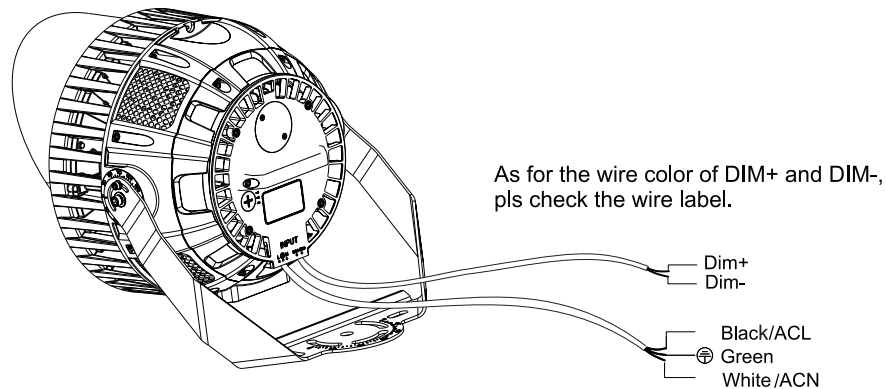

Notice: Please use the dimming+, dimming- (DC10V) marking leads to connect to outside dimmer.
 Class 1 Wiring Only.
 Please assure a cumulative leakage current of less than 3.5mA on the control circuit.
 The AUX control wire with shrinkable tubing shall not be damaged (no connection).

INSTALLATION INSTRUCTIONS WITH DIFFERENT BRACKETS

1.FLOOD MOUNTING(FM)

- 1: Fix the FM bracket to the heat sink with M10 screws (Figure 1);
- 2: Fix it with M6 screws after adjusting to the required the angle (Figure 2).

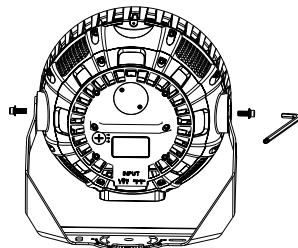

Figure 1

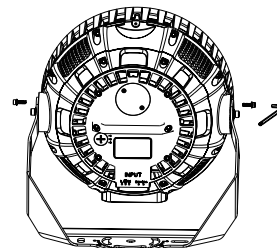

Figure 2

FLOOD MOUNTING METHOD 1 (POLE MOUNTING)

1. Mark the hole distance S1 shown in the product to be installed (Figure 3);
2. Drill two holes of distance S1 on the mounting bar (Figure 4).

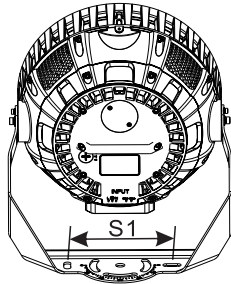

Figure 3

POWER	400/500W
1	7.48"

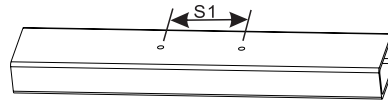

Figure 4

3. Install the luminaire on the crossbar and secure it with nuts, spring washers and flat washers (Figure 5).

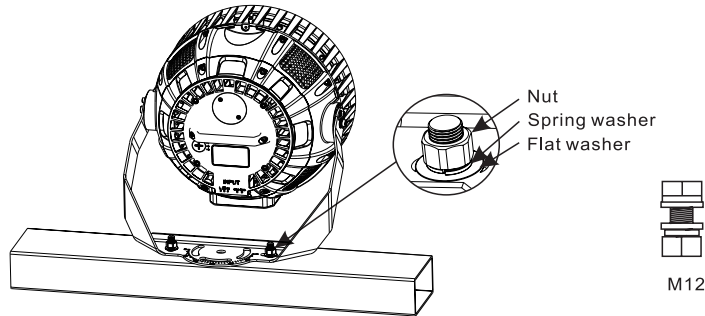

Figure 5

4. Use M6 hex wrench to loosen the adjustment screw used to adjust the angle (Figure 6).

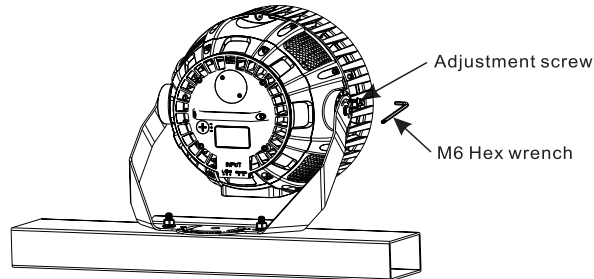

Figure 6

FLOOD MOUNTING METHOD 1 (POLE MOUNTING)

5. According to the need, adjust the projection angle, angle adjustment range;
 (Figure 7)

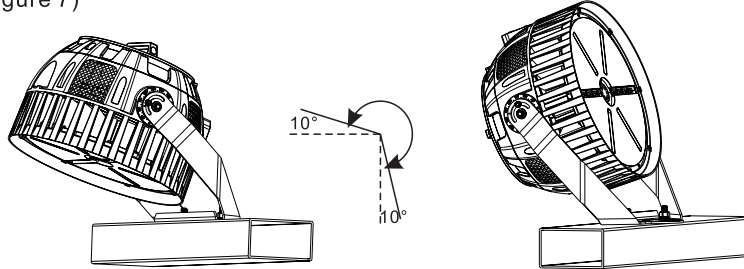

Figure 7

6. Complete the projection angle adjustment and lock the adjustment screw;
 7. According to the previous wiring diagram and select one desired method for wiring.

Notice: Please use listed water proof strain relief bushing when connection the supply cord to the outlet box.

INSTRUCTIONS FOR LIGHT SHIELD

When the light shield function is required, Fix the light barrier to the luminaire with a screwdriver as required. (Figure 8)

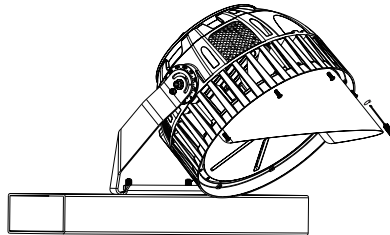

Figure 8

WATTAGE SELECTION

The light fixture with watt adjustable function, tear off the plug, switch it to the tap position you need. (300W,400W,500W,Factory setting:"500W") (Figure 9)

Note: only switch the tap position to "500W", the light fixture recover to the standard status.

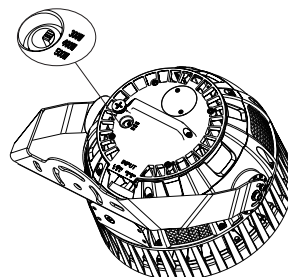

Figure 9