

MODEL :		TYPE
PROJECT :		
PREPARED BY :	DATE :	

## SERIES SPECIFICATIONS

ESR-LED-WP

The ESR-LED-WP series is a stylish wet location unit that offers two LED adjustable Lamp heads: along with a contemporary design, with quick installation all in an economical package.



## LINE DRAWING

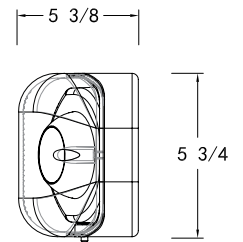
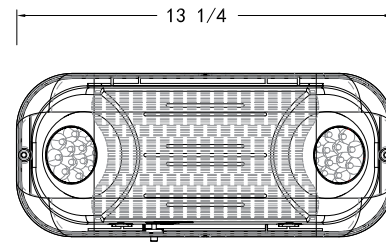
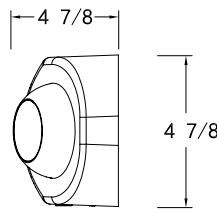
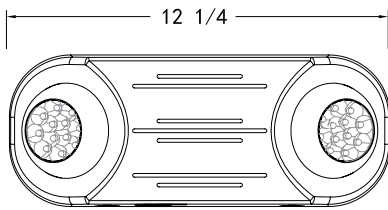

## CONSTRUCTION

### Housing

Injection molded, engineering grade, UV-stabilized, UL94-0, thermoplastic

### Transfer switch

Internal solid-state transfer switch automatically connects the internal battery to lamp heads

### Charger

Fully automatic solid-state, two rate charger initiates battery charging to recharge a discharged battery in 24 hours.

### Cover

Fully gasketed clear polycarbonate lens cover

### Lamp Heads

Two fully adjustable 12 LED glare-free lamp heads

## ELECTRICAL SPECIFICATIONS

### Battery Type

3.6V Rechargeable NiCad

### Emergency Illumination

Minimum 90 Minutes

### Battery Recharge Time

24 Hours

### Operating Voltage

120/277

### Frequency

60Hz

### Battery Discharge Time

1.5 Hours

APPLICATION AND PERFORMANCE SPECIFICATION INFORMATION IS SUBJECT TO CHANGE WITHOUT NOTIFICATION



MODEL :		TYPE
PROJECT :		
PREPARED BY :	DATE :	

## AMPERAGE/WATTAGE

CATALOG NUMBER	INPUT WATTS (W)		INPUT AMPS (A)	
	120V	277V	120V	277V
ESR-LED-WP	3.32	3.3	0.186	0.012

## MOUNTING SPECIFICATIONS

Universal J-box pattern knockout and universal mounting plate

Mounting plate comes standard with quick-connect feature

Suitable for wall mount

## CERTIFICATIONS/WARRANTY

Listing  
UL Listed

Compliance  
Meets UL924, cULus, NFPA 101 Life Safety Code, NEC, OSHA, Local and State Codes.

Location Rating:  
Suitable for wet locations

### Warranty

Guaranteed for five years from the purchase date of the product, against mechanical defects in manufacturing. Batteries are pro-rated for two years.

## ORDERING INFORMATION

Part Number: ESR-LED-WP

ESR	-LED	WP	
SERIES	LAMP TYPE	TYPE	HOUSING COLOR
ESR	[-LED] : LED	[WP] : Waterproof	[BLANK] : White
			[B] : Black

APPLICATION AND PERFORMANCE SPECIFICATION INFORMATION IS SUBJECT TO CHANGE WITHOUT NOTIFICATION