



PROJECT:	
LOCATION:	
MODEL#:	TYPE:
CLIENT:	QTY:
PREPARED BY:	DATE:

IC806R

SERIES SPECIFICATIONS

Tamlite Lighting's IC806R is designed for sloped remodel installations with a designated quick connect cable. Suitable for use in ceilings where the housing can be in direct contact with insulation. Airtight construction reduces energy costs by reducing the amount of air leakages through the ceiling.

Max lamp wattage: 75W R/PAR30, 60W A19

7 1/2" height allows use in 2" x 8" construction

Knockouts
(6) 1/2", (1) 3/4"

Pryouts
(4) Romex pryout with strain relief

Socket
Medium base porcelain socket on adjustable mounting bracket for proper lamp positioning.



LAMP SPECIFICATIONS

Base Type: E26 Base
Lamp Type: PAR30 / R30 / A19

ELECTRICAL SPECIFICATIONS

Rated Input Voltage: 120VAC

CERTIFICATIONS

Code Compliance: UL , cULus Listed for Feed Through , cULus Listed for Damp Location
Construction Standard: Certified under ASTM-E283 for Airtight Construction
Performance Certifications: Air Tight / IC Rated
Safety Certifications: UL Listed

ENVIRONMENTAL SPECIFICATIONS

UL Location Rating: Damp Location



PROJECT:	
LOCATION:	
MODEL#:	TYPE:
CLIENT:	QTY:
PREPARED BY:	DATE:

PHYSICAL SPECIFICATIONS

Housing Material: Galvanized Steel
Maximum Overall Diameter: 12.5in.

Weight: 1.6lbs

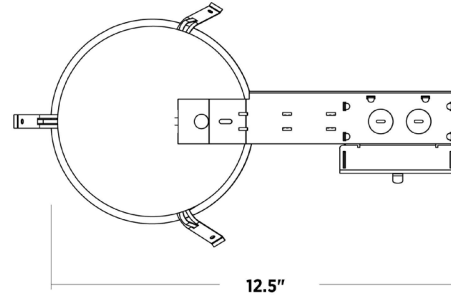
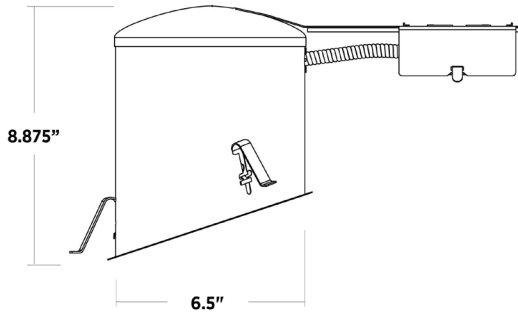

WARRANTY INFORMATION

Warranty: 1 Year



PROJECT:	
LOCATION:	
MODEL#:	TYPE:
CLIENT:	QTY:
PREPARED BY:	DATE:

SAMPLE PART #: IC806R

SERIES	SIZE	TYPE
IC	[806] : 6" Slope	[R] : Remodel

SHIPPING SPECIFICATIONS

Package

Length: 8.5in.
QTY: 6
QTY UOM: EA

Weight: 12.6lbs
Width: 22in.

Master Case

Height: 8.25 in.
Length: 25in.
QTY: 6

QTY UOM: EA
Weight: 12.75lbs
Width: 22in.

Pallet

QTY: 108
QTY UOM: EA