



PROJECT:	
LOCATION:	
MODEL#:	TYPE:
CLIENT:	QTY:
PREPARED BY:	DATE:

## ICL6ATQ

### SERIES SPECIFICATIONS

Tamlite Lighting's ICL6ATQ 6" LED dedicated IC housing is designed for new construction installations and suitable for use in ceiling where the housing can be in direct contact with insulation. Airtight construction reduces energy costs by reducing the amount of air leakages through the ceiling.



#### Bar Hangar

Adjustable from 13 5/8" to 25" Repositionable 90°

#### Knockouts

(1) 1/8" , (6) 7/8"

#### For Use With

120/277V LED Retrofit

#### Pryouts

(4) Romex pryout w/ strain relief

#### Ceiling Cutout Size

6.31"



### LAMP SPECIFICATIONS

**Base Type:** E26 Base

**Lamp Type:** LED RETRO

**Maximum Overall Diameter:** 10in.

**Maximum Overall Length:** 10in.

### ELECTRICAL SPECIFICATIONS

**Rated Input Voltage:** 120VAC

### CERTIFICATIONS

**Code Compliance:** UL

cULus Listed for Feed Through

cULus Listed for Damp Location

Title 24

**Construction Standard:** Certified under ASTM-E283 for Airtight Construction

Meets state of California title 24 requirement.

**Performance Certifications:** IC Rated / Air Tight / Title 24

**Safety Certifications:** UL Listed / cUL Listed



PROJECT:	
LOCATION:	
MODEL#:	TYPE:
CLIENT:	QTY:
PREPARED BY:	DATE:

## ENVIRONMENTAL SPECIFICATIONS

**UL Location Rating:** Damp Location

## PHYSICAL SPECIFICATIONS

**Housing Material:** Galvanized Steel  
**Weight:** 1.81lbs

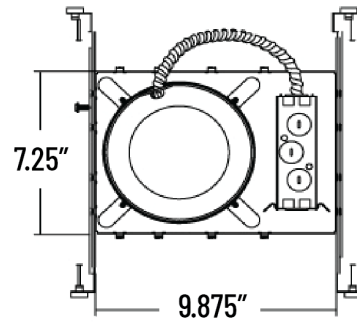
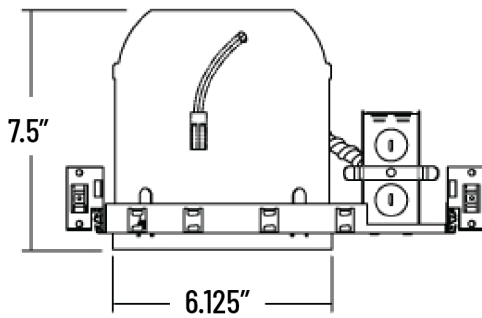

## WARRANTY INFORMATION

**Warranty:** 1 Year



PROJECT:	
LOCATION:	
MODEL#:	TYPE:
CLIENT:	QTY:
PREPARED BY:	DATE:

SERIES	SIZE	HOUSING	CONNECTOR
IC	[206] : 6"	[AT] : Air Tight	[Q] : Quick Connect

## SHIPPING SPECIFICATIONS

### Master Case

Height: 8.5 in.  
Length: 21 in.  
QTY: 6

QTY UOM: EA  
Weight: 22lbs  
Width: 19in.

### Pallet

QTY: 216  
QTY UOM: EA